

90 RESTART

GEWISS

RESTART RD/RD PRO/RM/RM PRO

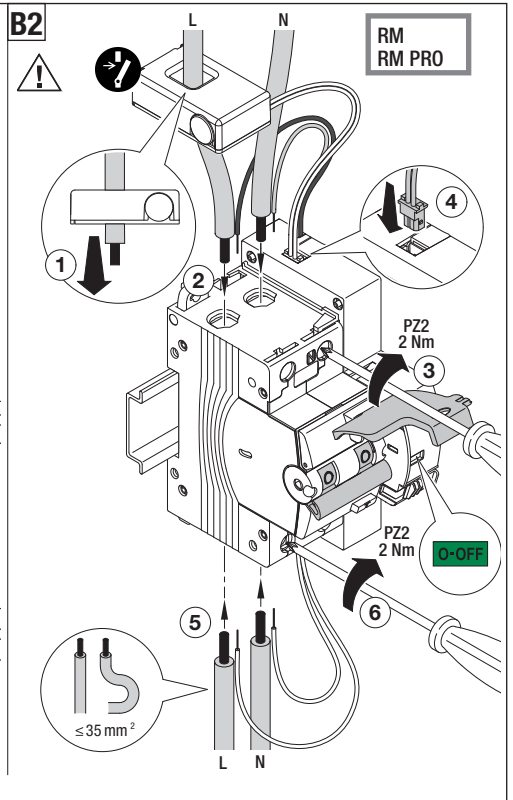

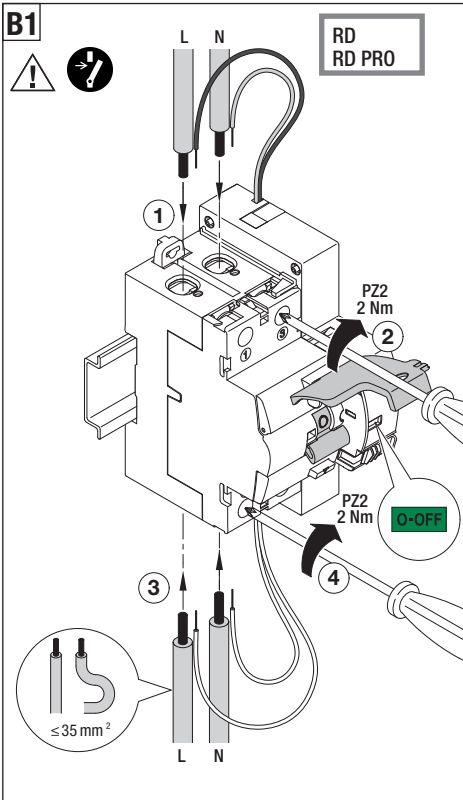
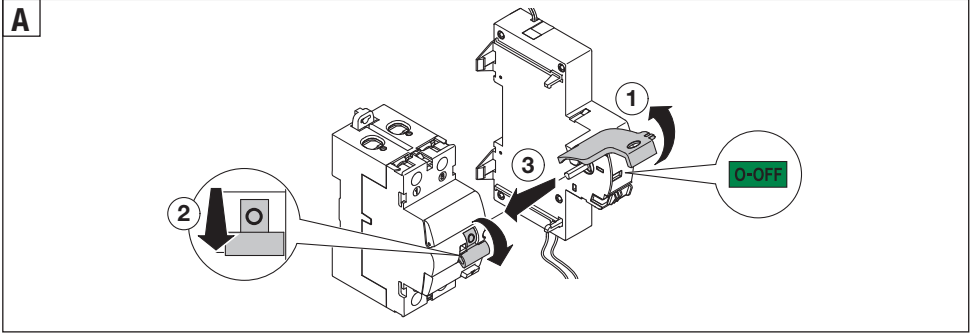

C

RD, RD PRO

TT, TN-S

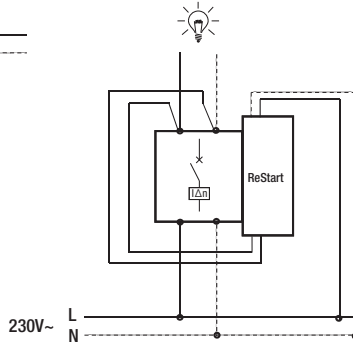
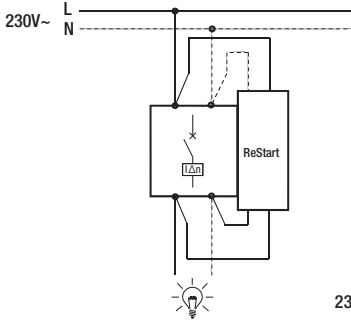

			Approval
	IDP NA 25-40-63A	6000A gG 63A	
	IDP 25-40A	10000A gG 63A	IMQ
	IDP 63A	10000A gG 80A	IMQ
	IDP 80-100A	6000A gG 100A	

RM, RM PRO

TT, TN-S

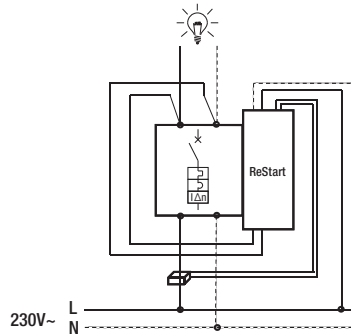
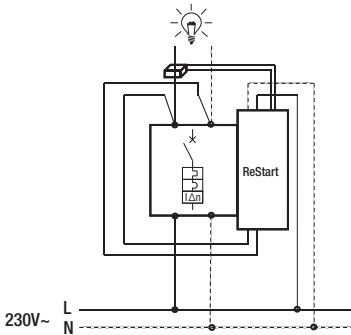
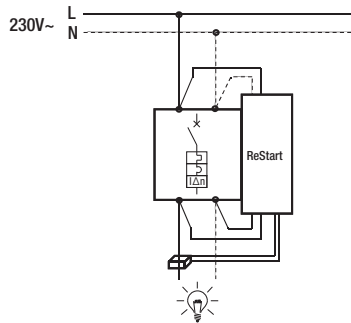
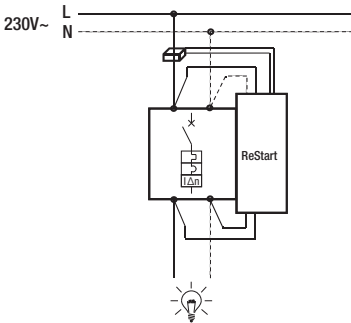

OFF → ON

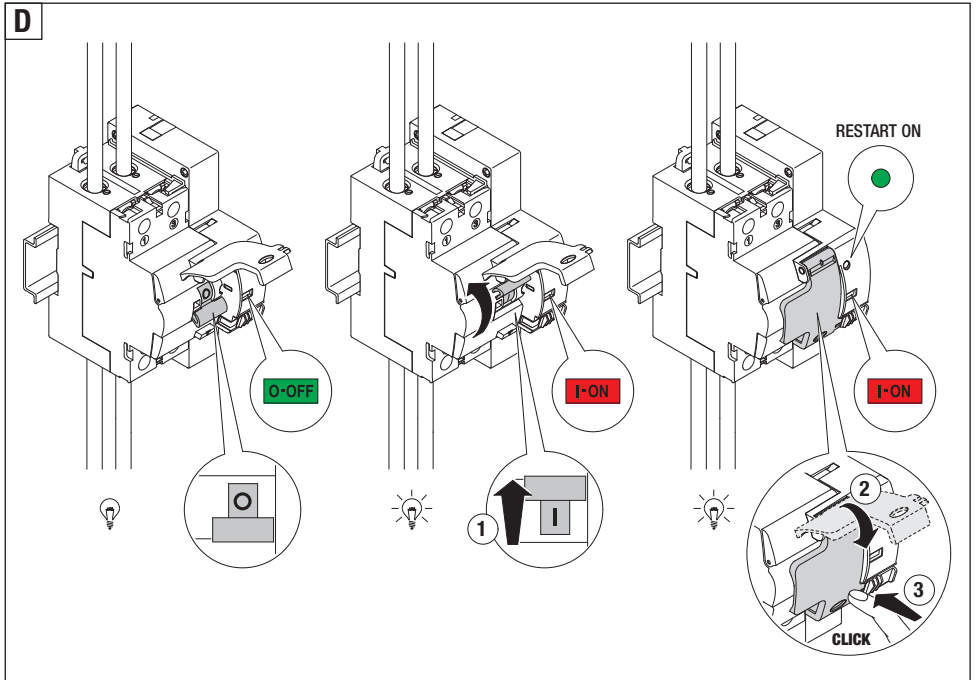

ON → OFF

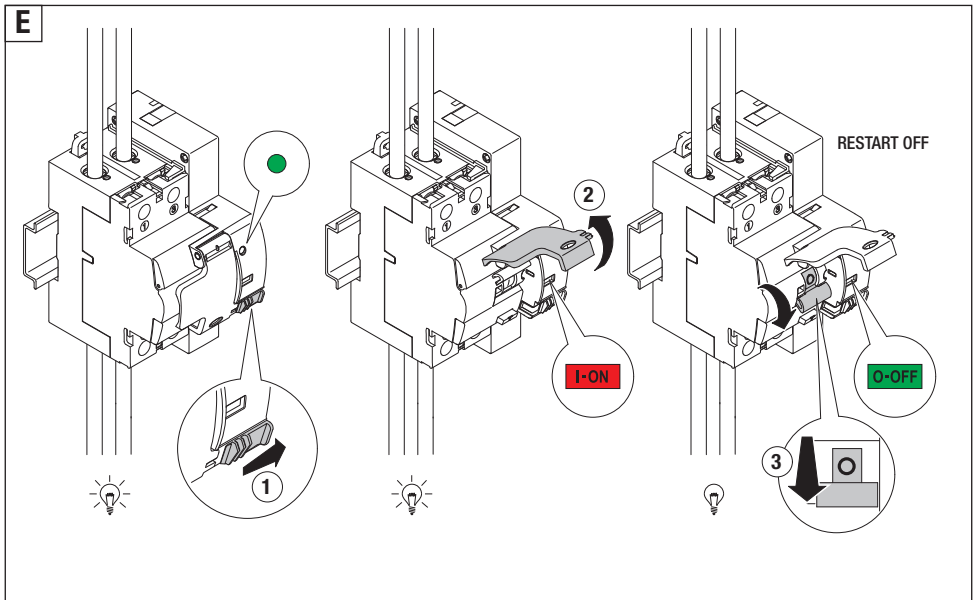

TEST



F



1,2,3 ... 12

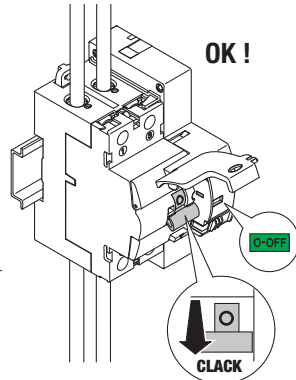
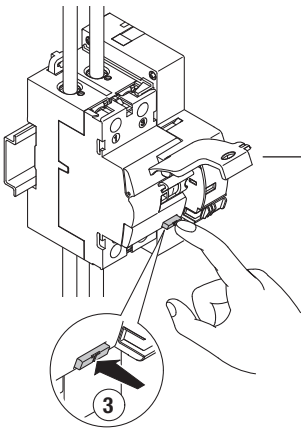
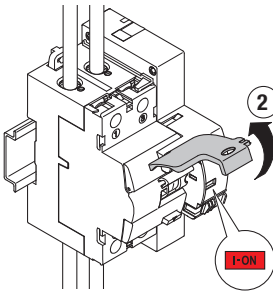
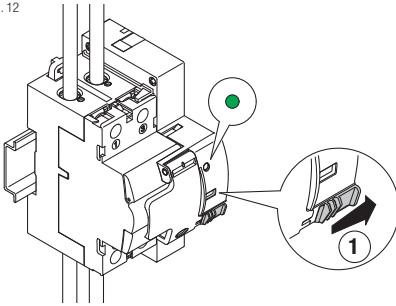

4A

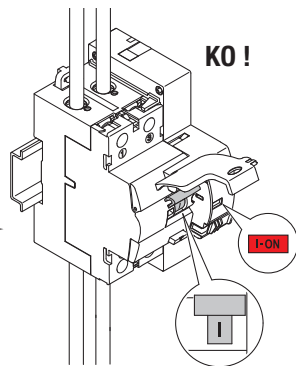

4B



TEST RESTART

G

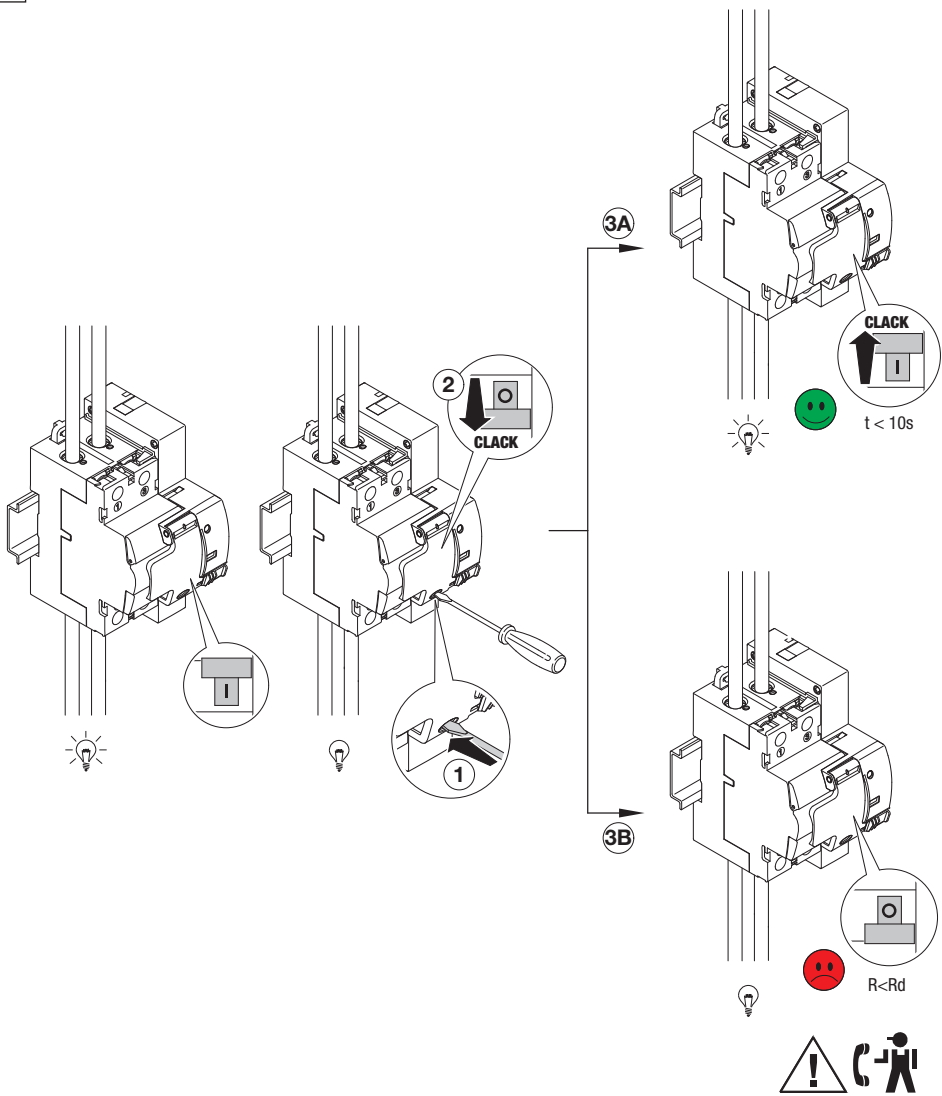

R=?

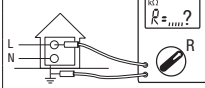

	RESTART RD / RD PRO	RESTART RM / RM PRO
30mA	100/300/500mA	
Rd	16kΩ	5kΩ
Rdo	8kΩ	2,5kΩ

RESTART RD

H

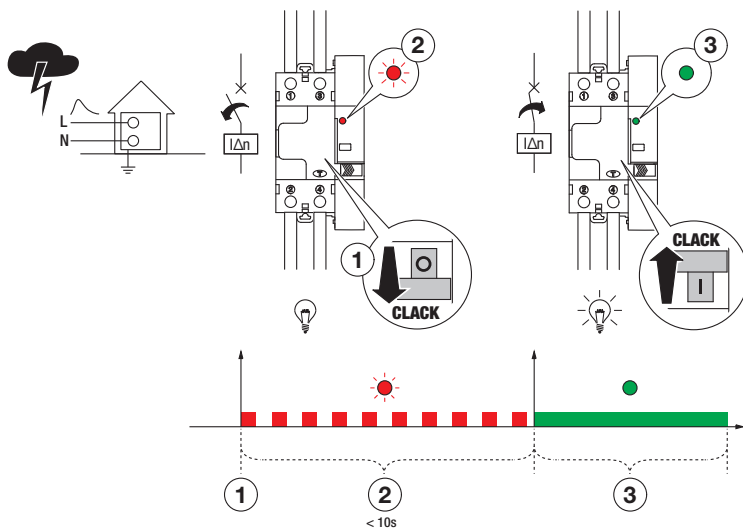

I

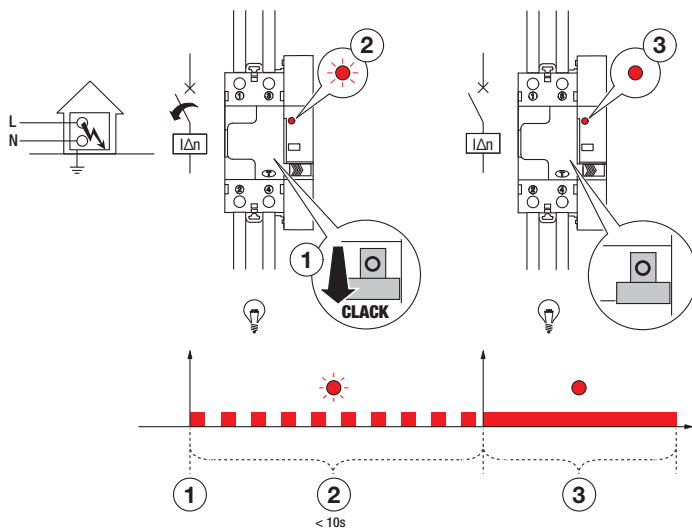

RESTART RD PRO

L

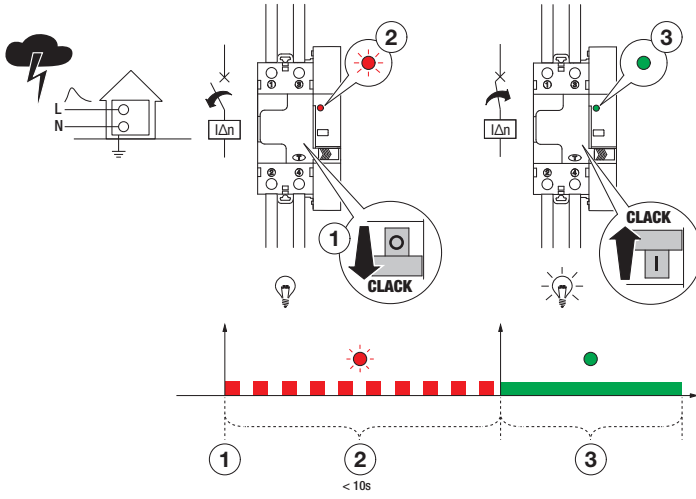

M

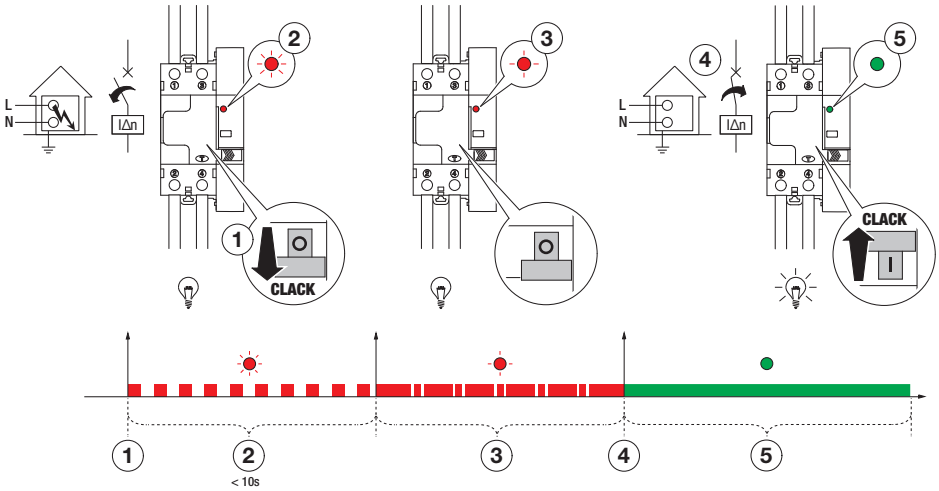

RESTART RM

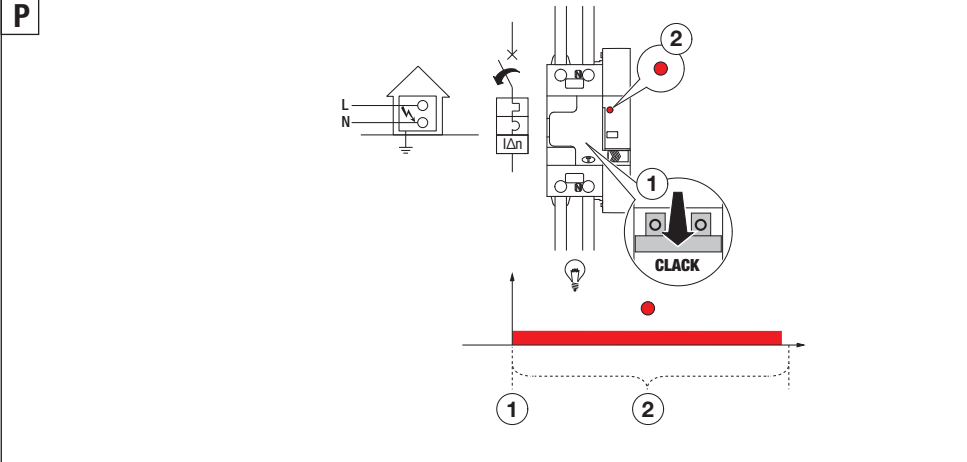
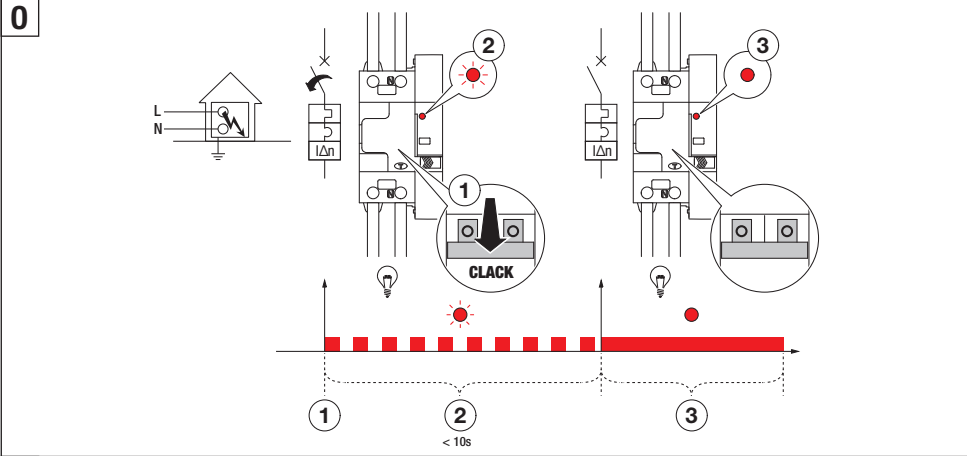
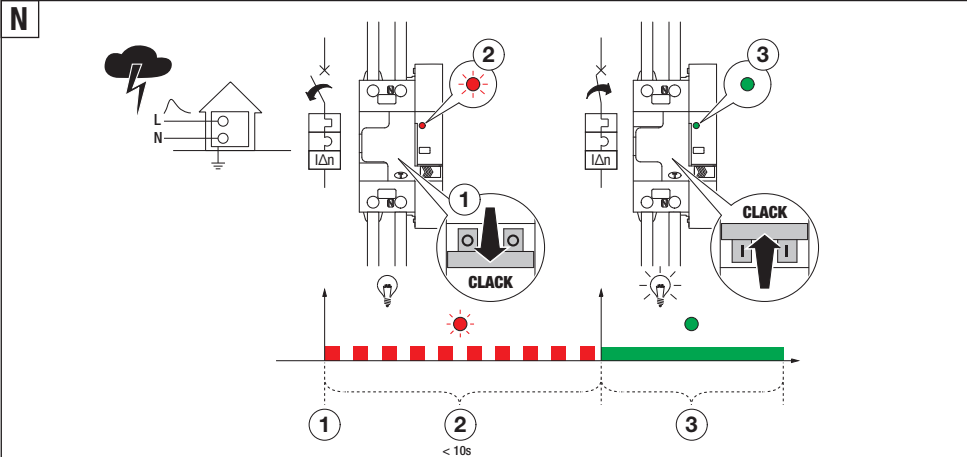

RESTART RM PRO

Q

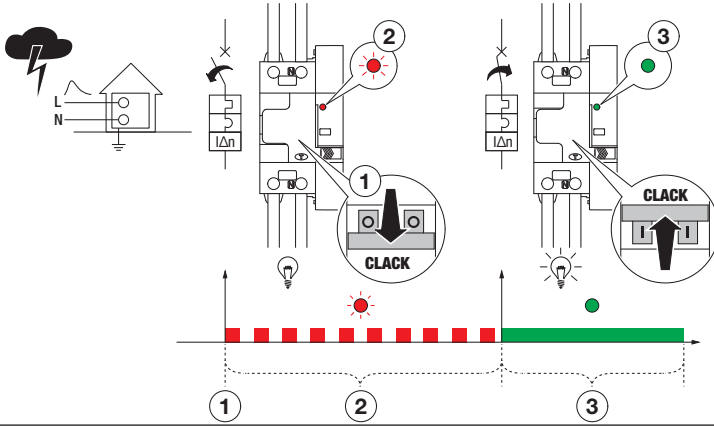

R

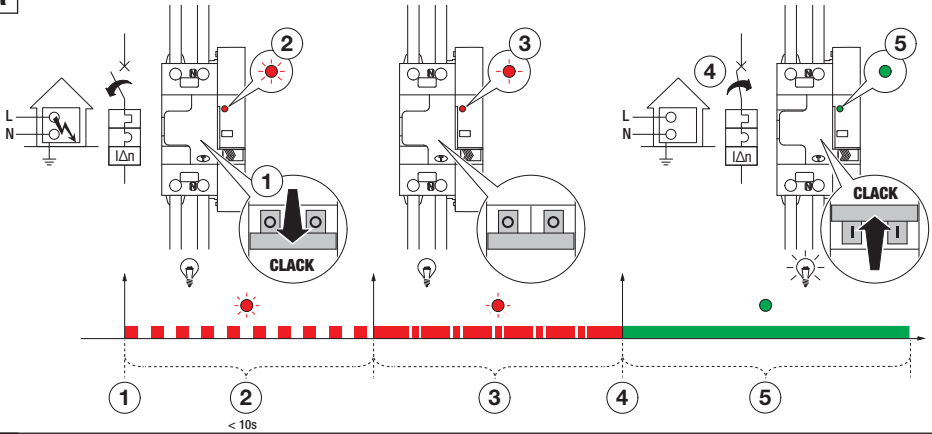



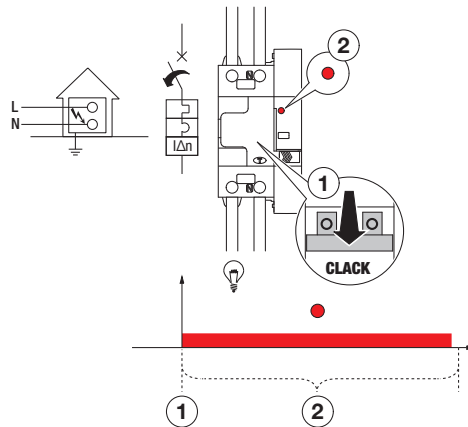

S







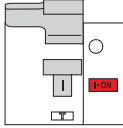

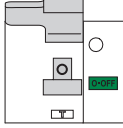

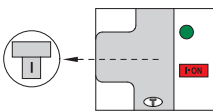

RESTART RD/RM

			
---	---	--	--

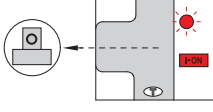
RESTART OFF

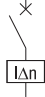
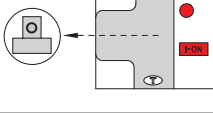
	I - ON 		
	O - OFF 		

RESTART ON

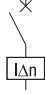
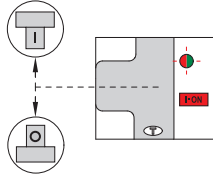
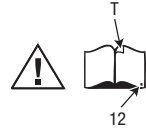

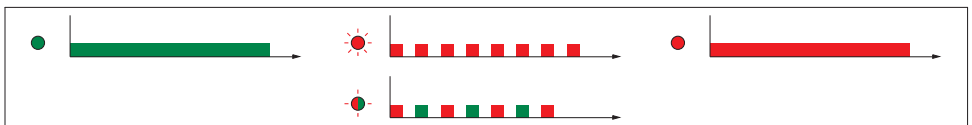

	I - ON 		
	O - OFF 		Restart (t < 10s)
	O - OFF 		
	I - ON  O - OFF 		







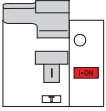

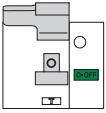





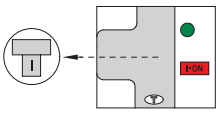

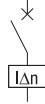
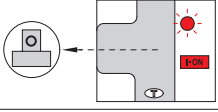
RESTART RD/RM PRO

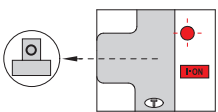
			
---	---	--	--

RESTART OFF

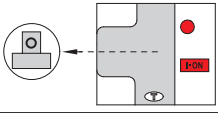
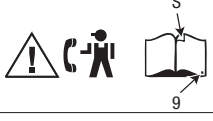
	I - ON 		
	0 - OFF 		

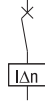
RESTART ON

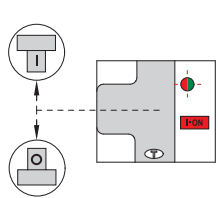
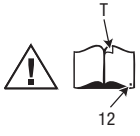
	I - ON 		
	0 - OFF 		Restart ($t < 10s$)
	0 - OFF 		
	0 - OFF 		
	I - ON  0 - OFF 		

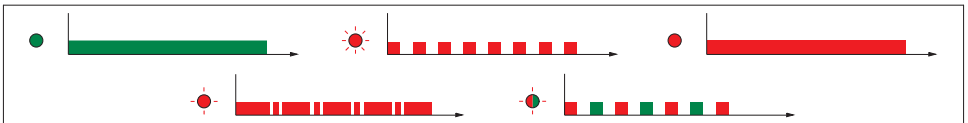

RESET

cod. 7.43.2.834.5

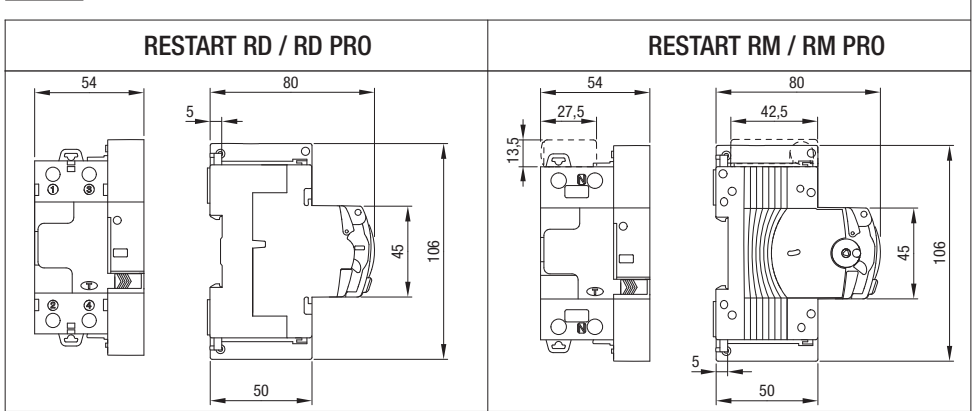
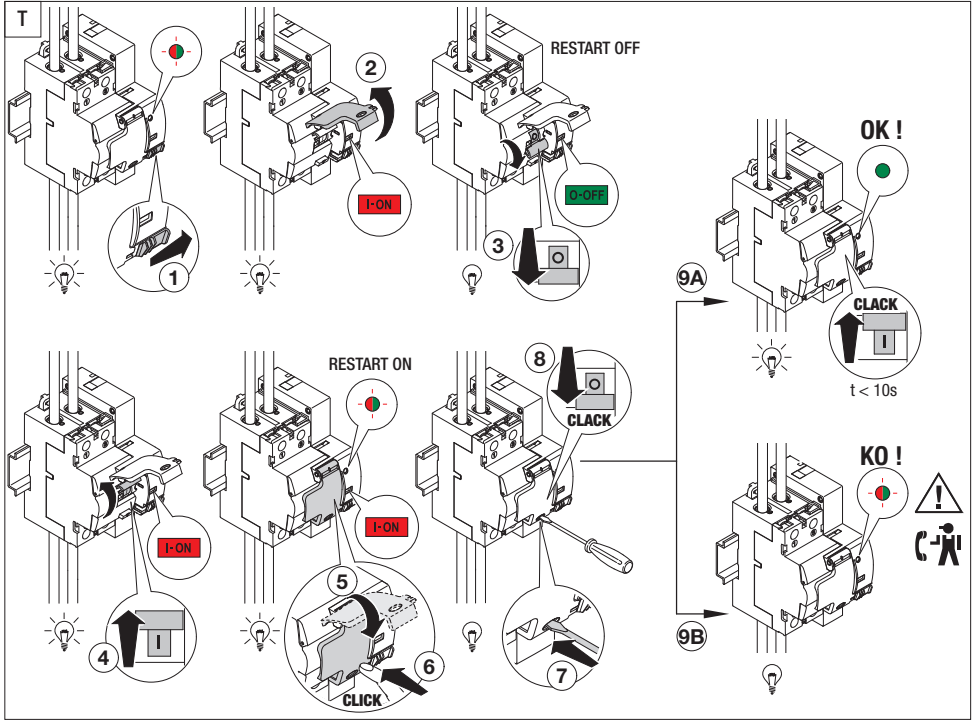

Punto di contatto indicato in adempimento ai fini delle direttive e regolamenti UE applicabili:
Contact details according to the relevant European Directives and Regulations:

GEWISS S.p.A. Via A.Volta, 1 IT-24069 Cenate Sotto (BG) Italy Tel: +39 035 946 111 E-mail: qualitymarks@gewiss.com



+39 035 946 111
8.30 - 12.30 / 14.00 - 18.00
lunedì - venerdì - monday - friday



+39 035 946 260



24h



sat@gewiss.com
www.gewiss.com

ULTIMA REVISIONE 10/2017